



Ashcombe Terrace
Tadworth - Offers Over £599,000

Johnson's
Independent Property Agents

Local people. Local knowledge.



the property



Ashcombe Terrace Tadworth

Offers Over £599,000

- 3 Bedroom Semi Detached Home
- 2 Bathrooms
- 2 Reception Rooms
- Utility Room and Conservatory
- Garden Workshop
- Driveway with parking for several vehicles
- A short walk to Local Amenities
- Tadworth Main Line stations Services to London Bridge & Victoria
- Open Day Saturday 27th September - By Appointment Only.
- Limited preview appointments available.

Johnson's are pleased to offer this extended and well-presented three-bedroom, two-bathroom semi-detached home located in a popular residential cul-de-sac in Tadworth Surrey. The property has been much improved by the current owners and is in excellent condition throughout. Open Day Saturday 27th September - By Appointment Only.



How energy efficient is the property?

Energy Efficiency Rating		
	Current	Potential
Very energy efficient - lower running costs		
92-100 A		80
81-91 B		
69-80 C		
55-68 D	64	
39-54 E		
21-38 F		
1-20 G		
Not energy efficient - higher running costs		
England & Wales		EU Directive 2002/91/EC

the layout

Ashcombe Terrace, Tadworth, KT20

Approximate Area = 1292 sq ft / 120 sq m

Outbuilding = 253 sq ft / 23.5 sq m

Total = 1545 sq ft / 143.5 sq m

For identification only - Not to scale

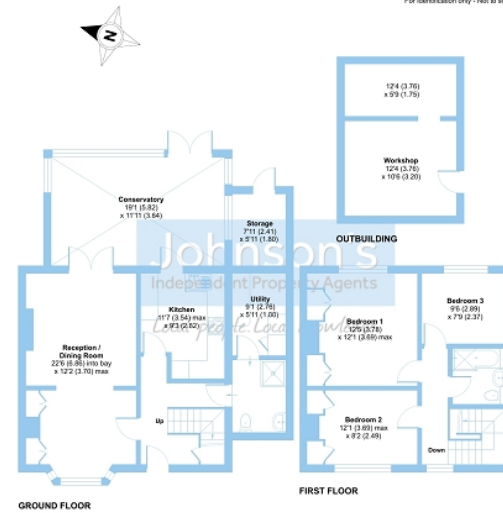



the local area



Johnson's
Independent Property Agents

Local people. Local knowledge.

Mail: johnsons@johnsons-ipa.co.uk **Web:** www.johnsons-ipa.co.uk
Addr: Johnson's IPA, Station House, Bunbury Way, Epsom, KT17 4JP
Sales: 01372 721722 **Lettings:** 01372 878545

