

Johnson's  
Independent Property Agents

*Local people. Local knowledge.*



£1,650 Monthly

Florence Court, Sunnyside, London



- Double Bedroom
- Fully Fitted Bathroom with shower
- Short walk to the District Line and Mainline Station
- Spacious Lounge
- Allocated Parking
- Walking distance to cafes, bars and restaurants in Wimbledon Village
- Modern Fitted Kitchen
- Idyllic Location for Wimbledon Village and Common
- Available from April 2025

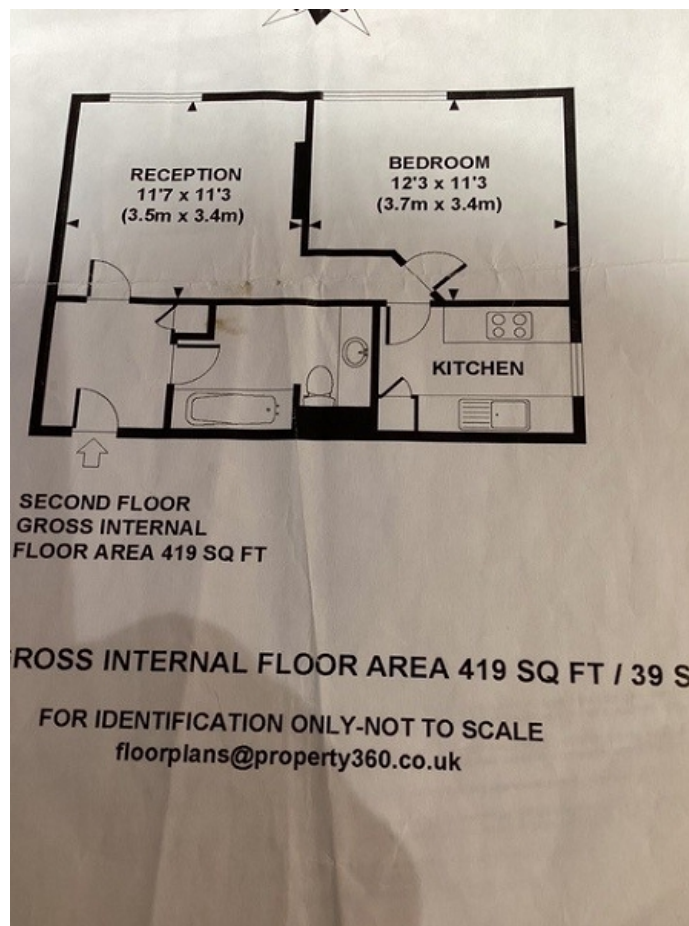

Johnson's are pleased to offer To Let this spacious, double bedroom apartment with private off street parking in a sought after road, just a short walk to Wimbledon Village and the Town Centre. The apartment is offered as unfurnished and is available from April 2025. Early viewing's are recommended to secure this rental in this highly sought after area of Wimbledon, just a short walk to Wimbledon Village and Town Centre with access to the District Line and Mainline Rail Station.

This fully refurbished property benefits from a large double bedroom with fitted wardrobes, a good size living room, modern fitted kitchen & bathroom with shower. There is allocated private off-street parking and the property is just a short walk a variety to excellent shops pubs, cafes and restaurants in both Wimbledon Village and Town Centre shopping as well as Wimbledon Common for relaxing outdoor walks. Nearby motorways with access to A3 London and the M25.

The apartment is offered as unfurnished and available from April 2025. Early viewing's are recommended to secure this rental in this highly sought after area of Wimbledon. Contact Sole Agents Johnson's Independent Property Agents for further information.

