



£2,600 Monthly

Kipings, Tadworth



- 4 Double Bedrooms
- Separate dining room with French doors to the rear garden
- Garden laid mostly to lawn with mature shrubs and borders
- Master Bedroom with ensuite
- A large light and airy Kitchen with integrated appliances and a separate Utility room
- Double Garage and driveway and parking for several vehicles
- Living room with feature fireplace
- Family Bathroom with a full size bath and shower.
- Easy waking distance to Tadworth village with a variety of local shops and Tadworth mainline railway station.

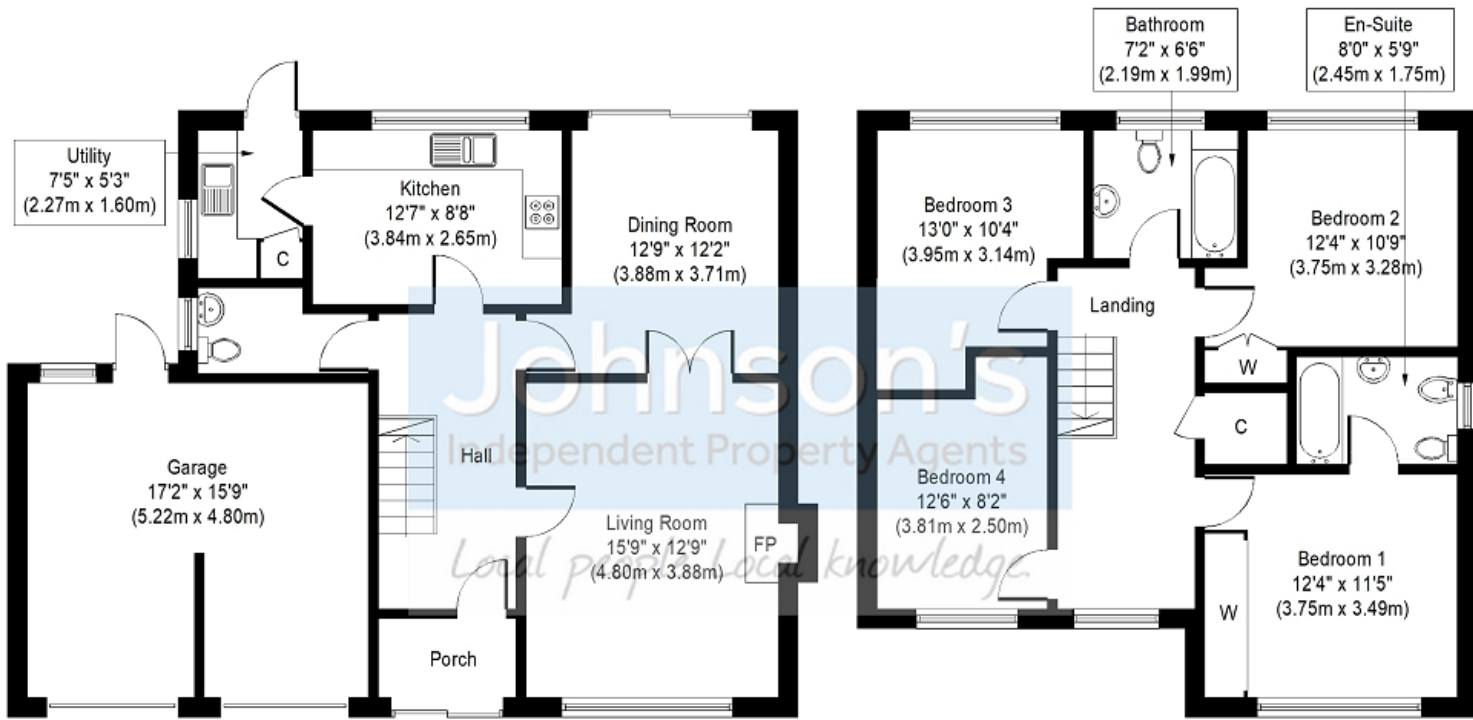

Whilst every attempt has been made to ensure the accuracy of the floor plan contained here, measurements of doors, windows, rooms and any other items are approximate and no responsibility is taken for any error, omission, or mis-statement. This plan is for illustrative purposes only and should be used as such by any prospective purchaser or tenant. The services, systems and appliances shown have not been tested and no guarantee as to their operability or efficiency can be given.
Copyright V360 Ltd 2020 | www.houseviz.com

Johnson's are pleased to offer To Let, this attractive four double bedroom detached family home with a double garage and parking for several vehicles, situated in a quiet sought after cul-de-sac in Tadworth Surrey KT20. The property is located just a short walk to Tadworth village with a selection of local shops, restaurants, and a mainline rail station with regular services to London Bridge and Victoria. The M25 junction 8 is approximately 4 miles away. Available Immediately. Pets accepted.

