



Oatfield Road
Tadworth - Guide Price £625,000

Johnson's
Independent Property Agents

Local people. Local knowledge.



the property



Oatfield Road Tadworth

Guide Price £625,000

- A beautifully presented Three Bedroom Semi-Detached family home
- Family Room - with half wood and framed panel walls, wood shelving and a feature Fireplace with a wood burner stove insert.
- A large Country Style Kitchen with space for a breakfast table, a Cloakroom, and a rear enclosed Porch / Utility area to access the rear patio and garden
- Loft Extension with Master Double Bedroom and modern ensuite shower room.
- Two further Double Bedrooms on the first floor.
- Victorian style bathroom with half panel walls and a full-size steel bath with brass taps, a fixed overhead rain shower

Johnson's are pleased to offer to market this beautifully presented Three Bedroom Semi-Detached Family home with current Planning approved for a Two-Story side and a Single-story rear extension. ** OPEN DAY Viewing's by appointment only - Saturday 13th January 2024.

Early bookings to secure a space on the Open Day are recommended as we expect demand to be high for this property.



How energy efficient is the property?

Energy Efficiency Rating		Current	Potential
Very energy efficient - lower running costs			
92-100	A		
81-91	B		86
69-80	C		
55-68	D	60	
39-54	E		
21-38	F		
1-20	G		
Not energy efficient - higher running costs			
England & Wales		EU Directive 2002/91/EC	

the layout

Oatfield Road, Tadworth, KT20

Approximate Area = 1146 sq ft / 106.4 sq m
 Garage = 154 sq ft / 14.3 sq m
 Total = 1300 sq ft / 120.7 sq m
 For identification only - Not to scale

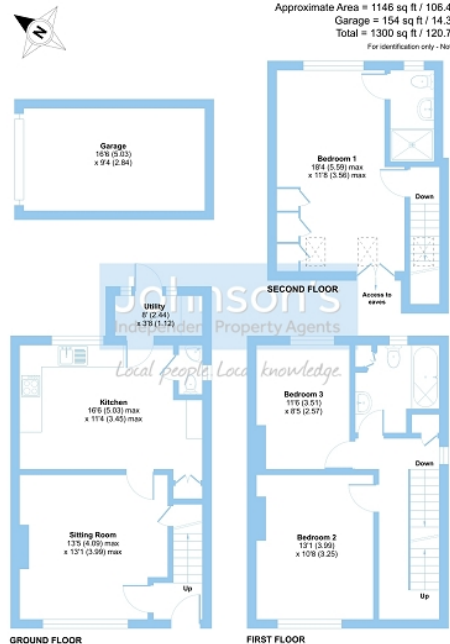



the local area



Johnson's

Independent Property Agents

Local people. Local knowledge.

Mail: johnsons@johnsons-ipa.co.uk **Web:** www.johnsons-ipa.co.uk
Addr: Johnson's IPA, Station House, Bunbury Way, Epsom, KT17 4JP
Sales: 01372 721722 **Lettings:** 01372 878545

